

Universal Hardware installed Prior to 1989

UNIVERSAL STYLE
 May 1, 1983 through
 Dec. 31, 1985

UNIVERSAL STYLE
 Jan. 1, 1986 through
 Dec. 31, 1988

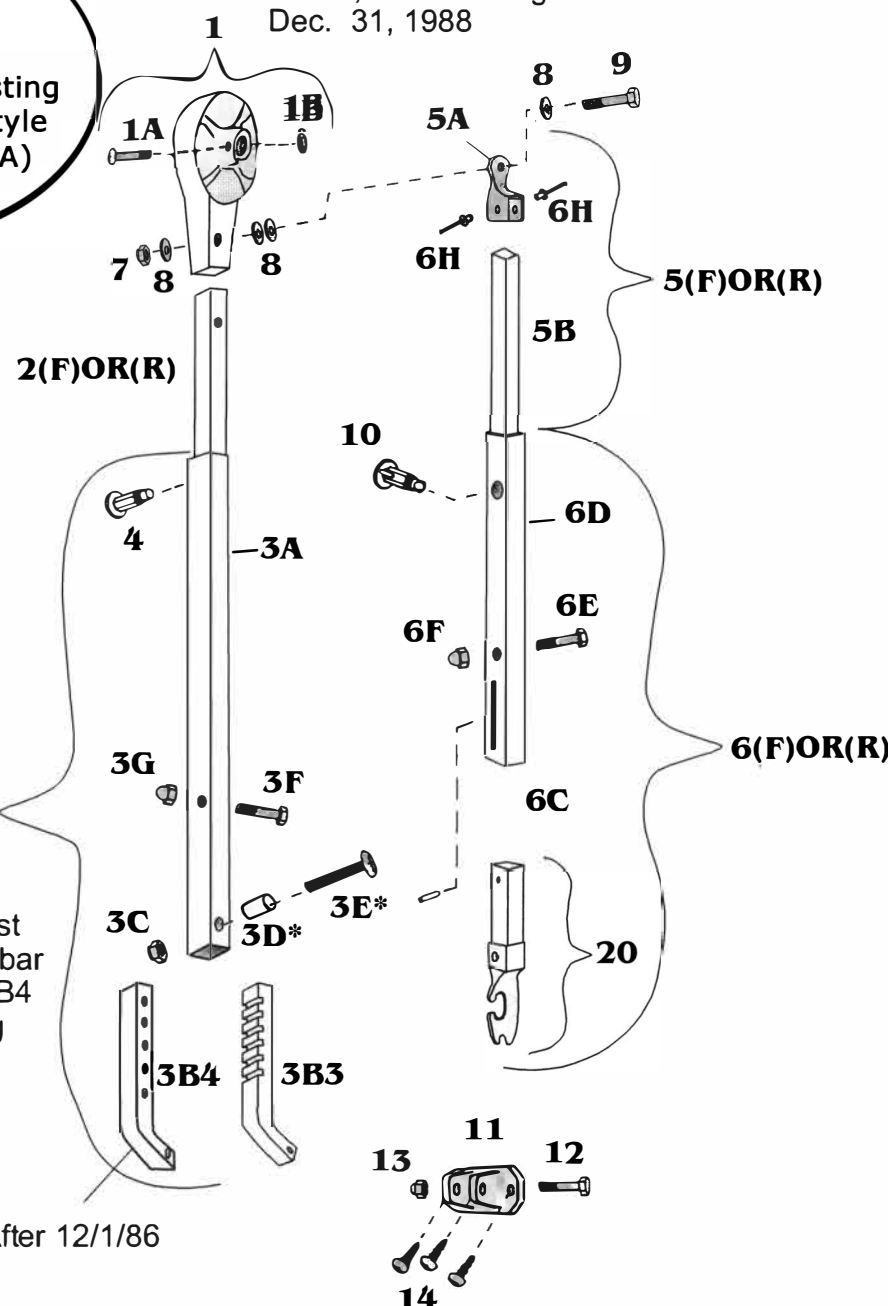
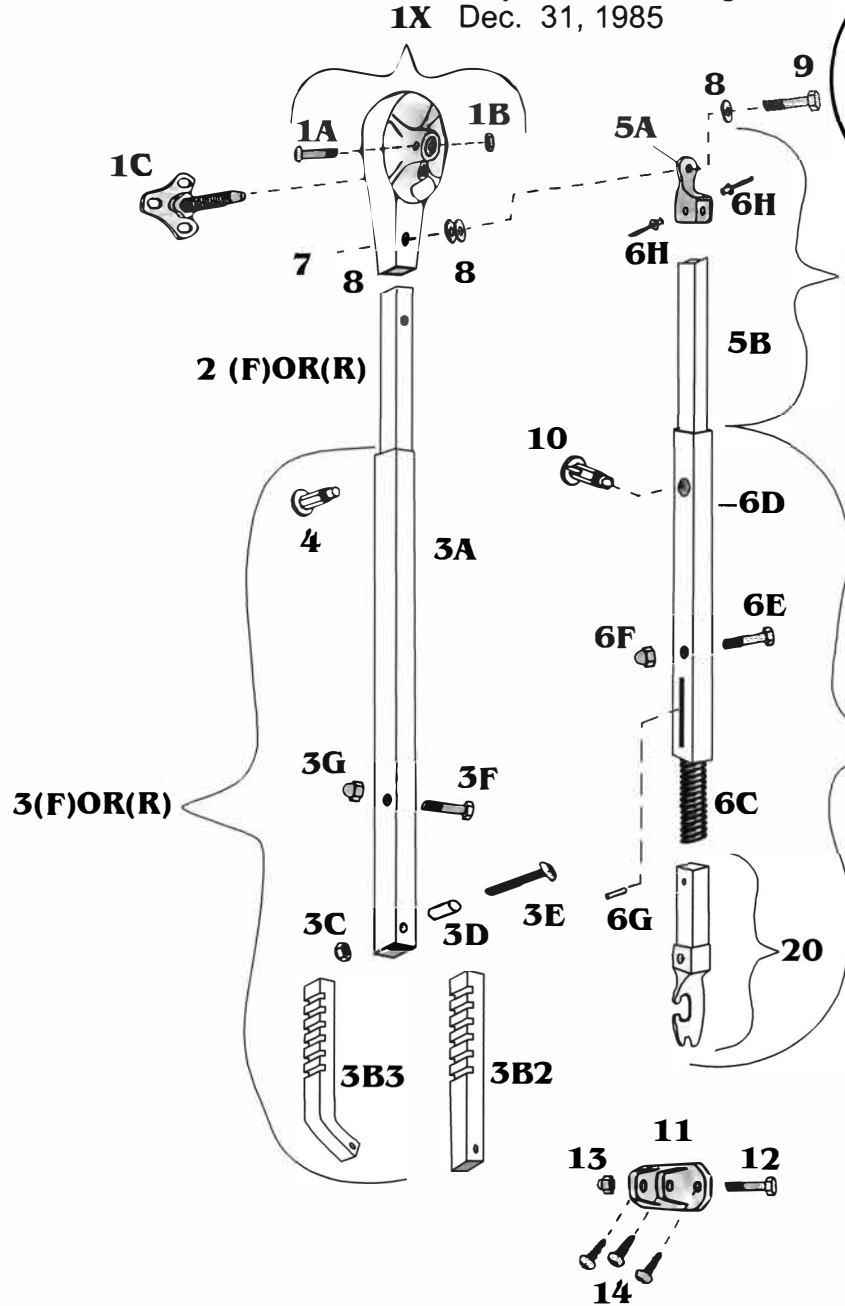
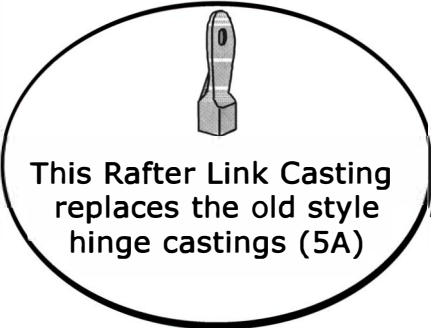

* Customer must specify hinge bar type 3B3 or 3B4 when ordering 3C, 3D or 3E

After 12/1/86

Ref #	PART #	UNIVERSAL HARDWARE installed Prior to 1989
1	215201	HEAD CASTING ASSEMBLY, STANDARD (red logo), includes:
1A	317212	BOLT, 10/32 x 1-1/2", HARDENED STEEL
1B	311070	NUT, 10/32, NYLOCK HEX (stainless)
1X	215001	'83 - '85 HEAD CASTING, THREADED, includes above
1C	215100	'83 - '85 THREADED ROLLER LOCK ASSEMBLY
2	219000-XXX	MAIN ARM BAR (stainless)
2	21901F/R-XXX	BRIGHT FRONT/REAR MAIN ARM BAR UC STYLE
3	21610F/R-XXX	BRIGHT FRONT/REAR MAIN ARM TUBE ASSEMBLY, includes:
3A	216000	'81 MAIN ARM TUBE ONLY
3A	216100	'88 MAIN ARM TUBE ONLY
3B	216500-XXX	'83 SLOTTED, BENT US/UC HINGE BAR
3B	216600-XXX	'88 CENTER DRILLED, BENT US/UC HINGE BAR
3C	311070	NUT, 10/32, NYLOCK HEX (stainless)
3C	311060	NUT, 1/4 - 20, NYLOCK HEX (stainless)
3D	325214	SPACER, 1/4" X 2/3" (aluminum)
3E	317203	STUD PIN, 1/4 - 20 X 2"
3F	310040	BOLT, 1/4 - 20 X 1-1/4", HEX HEAD
3G	311020	CAP NUT, 1/4 - 20 (aluminum)
4	290002	SNAP STUD ASSEMBLY
5	21710F/R-XXX	BRIGHT FRONT/REAR RAFTER ARM BAR ASSEMBLY, includes:
5A	210360	RAFTER LINK CASTING
5B	217100-XXX	BRIGHT RAFTER ARM BAR
5C	316100	RIVET, 5/32, BLIND (stainless)
6	218210	BRIGHT RAFTER ARM TUBE ASSEMBLY, includes:
6C	322110	COMPRESSION SPRING, 4-1/4"
6D	218200	BRIGHT RAFTER ARM TUBE
6E	310030	BOLT, 1/4 - 20 X 1-3/8", HEX HEAD
6F	311020	CAP NUT, 1/4 - 20 (aluminum)
6G	313220	GUIDE PIN, 1/8 X 5/8
6H	316100	RIVET, 5/32, BLIND (stainless)
20	218611	BRIGHT CLAW AND BAR ASSEMBLY WITH PIN
10	290001	RATCHET STUD ASSEMBLY
11	210060	BASE HINGE, RECTANGULAR (floor mount)
	299501	UNIVERSAL HARDWARE MOUNTING KIT, includes:
7	311060	(2) NUT, 1/4 - 20, NYLOCK HEX (stainless)
8	312070	(8) WASHER, FLAT
9		(2) BOLT, 1/4 - 20 X 1-3/4, HEX HEAD
12	310010	(2) BOLT, 1/4 - 20 X 1-5/8", HEX HEAD
13	311010	(2) NUT, 1/4 - 20, ACORN CAP (stainless)
14	317040	(6) SCREW, 14 X 2" SHEET METAL (stainless)
	1HD20(F/R)-XXX	BRIGHT HALF SET OF HARDWARE, FRONT/REAR

(XXX) - YEAR, MAKE, MODEL OF COACH REQUIRED

