

Chair... Add-A-Lounge

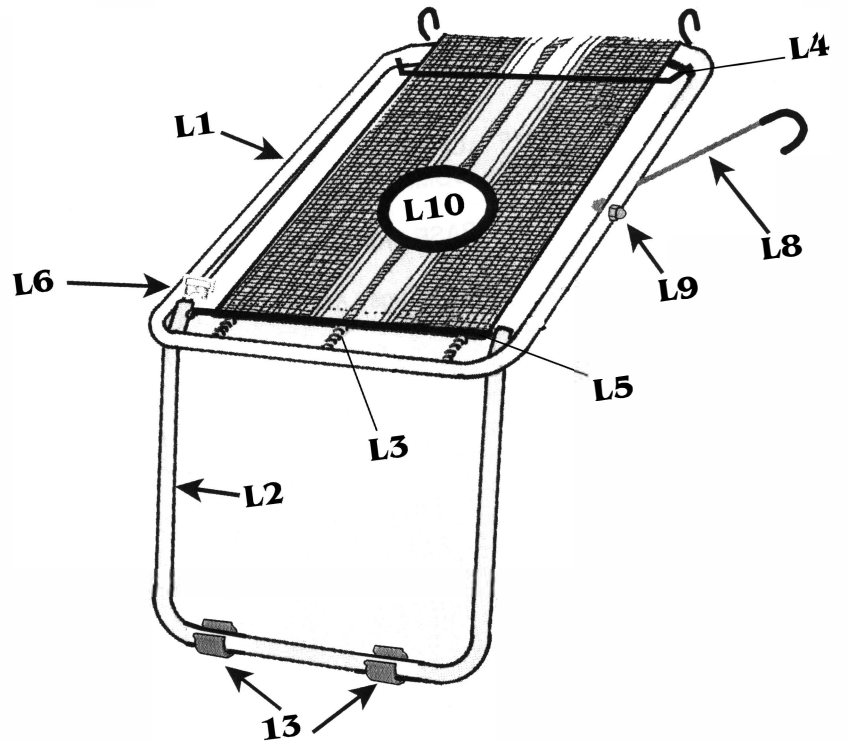
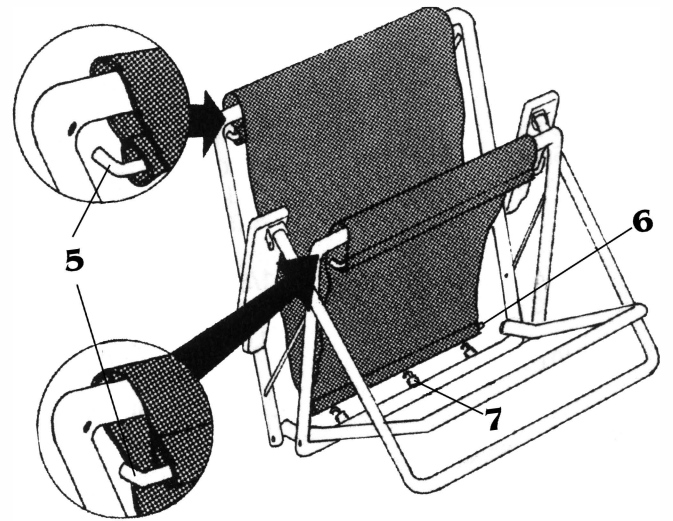
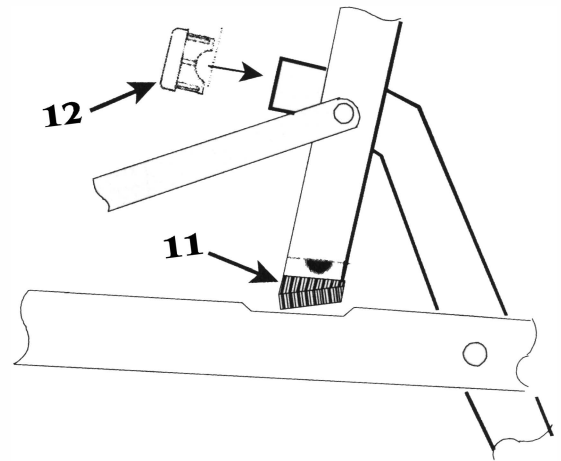
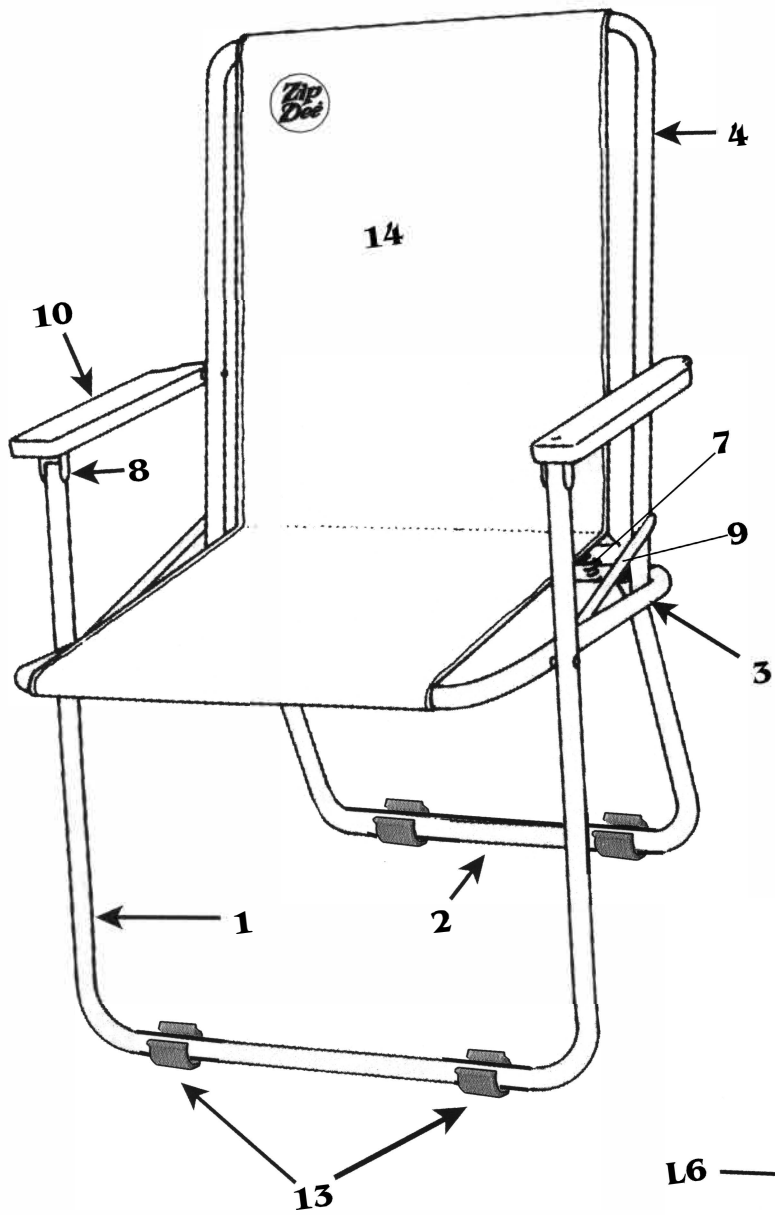

Ref #	PART #	CHAIR - STANDARD AND WIDE
1	900050	LEG, CHAIR, FRONT (standard)
	900180	LEG, CHAIR, FRONT (wide)
2	900060	LEG, CHAIR, REAR (standard)
	900190	LEG, CHAIR, REAR (wide)
3	900070	RING, CHAIR (standard)
	900200	RING, CHAIR (wide)
4	900080	BACK REST, CHAIR (standard)
	900210	BACK REST, CHAIR (wide)
5	322020	RETAINING ROD, 16-1/4", BENT (standard)
	322140	RETAINING ROD, 18-1/4", BENT (wide)
6	322030	TENSION ROD, 14-1/4", STRAIGHT (standard)
	322150	TENSION ROD, 16-1/4", STRAIGHT (wide)
7	322060	SPRING, CHAIR
8	325170	BRACKET, ARM
9	325010	BRACE
10	323010	ARMREST, ASH/OAK (without bracket)
11	321320	PLUG, NYLON WITH FIN
12	321020	PLUG, NYLON, FLAT TOP
13	321271	Z-PAD, SINGLE
	1ZP000	Z-PADS, 8 PACK
14	1CF100	CHAIR FABRIC, 14-1/4" (standard)
14	1CF200	CHAIR FABRIC, 16-1/4" (wide)

ADD-A-LOUNGE - STANDARD AND WIDE

L1	900111	RING, LOUNGE (standard)
L1	900271	RING, LOUNGE (wide)
L2	900121	LEG, LOUNGE (standard)
L2	900281	LEG, LOUNGE (wide)
L3	322060	SPRING, CHAIR
L4	322040	RETAINING ROD, 16-7/8", STRAIGHT (standard)
L4	322160	RETAINING ROD, 18-7/8", STRAIGHT (wide)
L5	322030	TENSION ROD, 14-1/4", STRAIGHT (standard)
L5	322150	TENSION ROD, 16-1/4", STRAIGHT (wide)
L6	321020	PLUG, NYLON, FLAT TOP
L8	322251	COATED STABILIZING ROD
L9	311100	NUT, ACORN
L10	1AF100	LOUNGE FABRIC, 14-1/4" (standard)
L10	1AF200	LOUNGE FABRIC, 16-1/4" (wide)

